

KINSHOFER Gear Type Rotator with Shaft up to 6600 lbs Load Capacity (incl. Fittings)

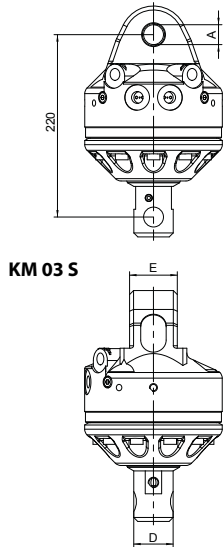

KM 03 S

Type	Load capacity (lbs)	Shaft Ø D (in)	Upper connection (Width E x Pin-Ø A) (in)	Torque (ft.lbs.)	Moment of deflection max (ft.lbs.)	Self weight (lbs)
KM 03 S	6600	1.95	2.36 x 0.98	332	1290	53



KM 03 S

Operating pressure: 4640 psi
 Pump capacity: 6.6 - 15.9 GPM
 Hydraulic coupling - in: G 3/8''
 Hydraulic coupling - out: G 1/4''

KINSHOFER Gear Type Rotator with Shaft up to 9900 lbs Load Capacity (incl. Fittings)



KM 04 S

Type	Load capacity (lbs)	Shaft Ø B (in)	Upper connection (Width C x Pin-Ø A) (in)	Torque (ft.lbs.)	Moment of deflection max (ft.lbs.)	Self weight (lbs)
KM 04 S59-30	9900	2.32	3.3 x 1.2	627	2213	57
KM 04 S	9900	2.44	3.3 x 1.2	627	2213	57
KM 04 S63-30	9900	2.48	3.3 x 1.2	627	2213	57
KM 04 S68-30	9900	2.68	3.3 x 1.2	627	2213	57
KM 04 S68-30S*	9900	2.68	3.3 x 1.2	627	2213	59
KM 04 S69-30	9900	2.72	3.3 x 1.2	627	2213	57



KM 04 S69-30

* steel motor-head

Operating pressure: 2880 - 5328 psi**
 Pump capacity: 6.6 - 15.9 GPM
 Hydraulic couplings: M 18 x 1,5

! Pump capacity/Operating pressure
 > 10.56 GPM / 2880 psi
 ≤ 10.56 GPM / 5328 psi

KINSHOFER Gear Type Rotator with Flange up to 9900 lbs Load Capacity (incl. Fittings)

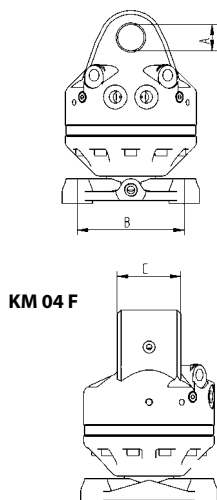

KM 04 F

Type	Load capacity (lbs)	Hole pattern of flange B (in)	Upper connection (Width C x Pin-Ø A) (in)	Torque (ft.lbs.)	Moment of deflection max (ft.lbs.)	Self weight (lbs)
KM 04 F	9900	□ 5.5	3.3 x 1.2	627	2213	57
KM 04 F140-30S*	9900	□ 5.5	3.3 x 1.2	627	2213	57
KM 04 F140-30US*	9900	□ 5.5	3.3 x 1.2	738	6269	68
KM 04 F140-30V**	9900	□ 5.5	3.3 x 1.2	627	2213	57



KM 04 F

* steel motor-head
 **additional vertical connection for the drive unit

Operating pressure: 2880 - 5328 psi
 Pump capacity: 6.6 - 15.9 GPM
 Hydraulic couplings: M 18 x 1,5

! Pump capacity/Operating pressure
 > 10.56 GPM / 2880 psi
 ≤ 10.56 GPM / 5328 psi



KM 04 F140-30US

Product Range

KINSHOFER Rotator Line

KINSHOFER Gear Type Rotator with Shaft up to 13200 lbs Load Capacity (incl. Fittings)

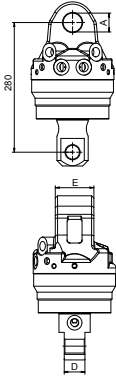

Type

Type	Load capacity (lbs)	Shaft Ø D (in)	Upper connection (Width E x Pin-Ø A) (in)	Torque (ft.lbs.)	Moment of deflection max (ft.lbs.)	Self weight (lbs)
KM 06 S68-40	13200	2.68	3.3 x 1.6	738	3319	70

Operating pressure: 2880 - 5328 psi
Pump capacity: 6.6 - 21.1 GPM
Hydraulic couplings – in: G 1/2''
Hydraulic couplings – out: M 18 x 1,5

! Pump capacity/Operating pressure
 > 10.56 GPM / 2880 psi
 ≤ 10.56 GPM / 5328 psi



KINSHOFER Gear Type Rotator with Flange up to 13200 lbs Load Capacity (incl. Fittings)

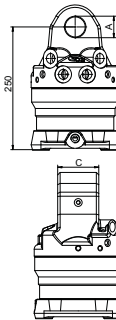

Type

Type	Load capacity (lbs)	Hole pattern of flange G (in)	Upper connection (Width E x Pin-Ø A) (in)	Torque (ft.lbs.)	Moment of deflection max (ft.lbs.)	Self weight (lbs)
KM 06 F140-40	13200	□ 5.5	3.3 x 1.6	738	6269	75

Operating pressure: 2880 - 5328 psi
Pump capacity: 6.6 - 21.1 GPM
Hydraulic couplings – in: G 1/2''
Hydraulic couplings – out: M 18 x 1,5

! Pump capacity/Operating pressure
 > 10.56 GPM / 2880 psi
 ≤ 10.56 GPM / 5328 psi



KINSHOFER Gear Type Rotator with Flange and 4 Oil Ducts to operate 2 different Functions (incl. Fittings)

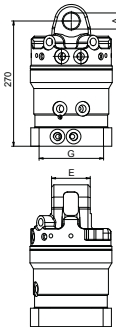

Type

Type	Load capacity (lbs)	Hole pattern of flange G (in)	Upper connection (Width E x Pin-Ø A) (in)	Torque (ft.lbs.)	Moment of deflection max (ft.lbs.)	Self weight (lbs)
KM 04 F140-30-4	9900	□ 5.5	3.3 x 1.2	629	2213	88
KM 06 F173-35-4	13200	Ø 6.8	3.2 x 1.4	738	6269	99
KM 10 F173-35/2-4	22000	Ø 6.8	3.2 x 1.4	1475	8850	158

	KM 04 F140-30-4	KM 06 F173-35-4	KM 10 F173-35/2-4
Operating pressure:	2880 - 5328 psi	2880 - 5328 psi	2880 - 5328 psi
Pump capacity:	6.6 - 15.9 GPM	6.6 - 26.4 GPM	6.9 - 26.4 GPM
Hydraulic couplings (Rotator and Grapple):	M 18 x 1,5	G 1/2''	G 1/2'' and G 3/4''



KM 04 F140-30-4

! Pump capacity/Operating pressure
 > 10.56 GPM / 2880 psi
 ≤ 10.56 GPM / 5328 psi

KM 04 F140-30-4

KINSHOFER Gear Type Rotator with Flange for Logging (incl. Hose Guard and Fittings)

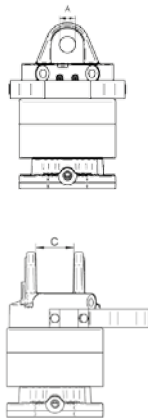

Type

Type	Load capacity (lbs)	Hole pattern of flange B (in)	Upper connection (Width C x Pin-Ø A) (in)	Torque (ft.lbs.)	Moment of deflection max (ft.lbs.)	Self weight (lbs)
KM 06F 173-35	13200	Ø 6.8	3.2 x 1.4	738	6269	75
KM 10F 173-35/1	22000	Ø 6.8	3.2 x 1.4	1475	8850	136
KM 10F 173-35/2	22000	Ø 6.8	3.2 x 1.4	1475	8850	143
KM 10F 173-45	22000	Ø 6.8	3.9 x 1.8	1475	8850	150
KM 10F 173-52	22000	Ø 6.8	5.4 x 2.1	1475	8850	154

Operating pressure: 2880 - 5328 psi
Pump capacity: 6.6 - 26.4 GPM
Hydraulic couplings (Rotator and Grapple): G 1/2''

! Pump capacity/Operating pressure
 > 10.56 GPM / 2880 psi
 ≤ 10.56 GPM / 5328 psi



KM 10F 173-35/1

KM 10F 173-35/1